

Bottom Releasable Guidepost - GPBR

Anchor for lifting shall have either Safety Sleeve or Safety Clip

- The Locking mechanism is provided with a device to prevent it from coming loose due to vibrations in the structure onto which it is welded
- Different diameters of the Guide Post Body and length are available
- Special dimensions can be calculated to match required length and load
- Interface towards standard Imenco Guideline anchor at top
- Requires no special Anchor or tool to operate the locking mechanism
- Imenco supplies receptacles that interface these Guideposts
- The receptacles are foreseen to be welded to the subsea structure
- Left and Right versions for the Locking mechanisms exist
- Extra-long arm on the lock may be supplied when the Receptacle is located in a inaccessible place
- The Lock is ROV friendly
- Standard or Standard Slimline Anchor may be used for Guide Wire
- Anchor for lifting shall have either Safety Sleeve or Safety Clip



For further information, email
commercial@imenco.com

Bottom Releasable Guidepost - GPBR

Accessories for Bottom releasable guidepost

- Standard or Standard Slimline Anchor may be used for Guide Wire
- Anchor for lifting shall have either Safety Sleeve or Safety Clip

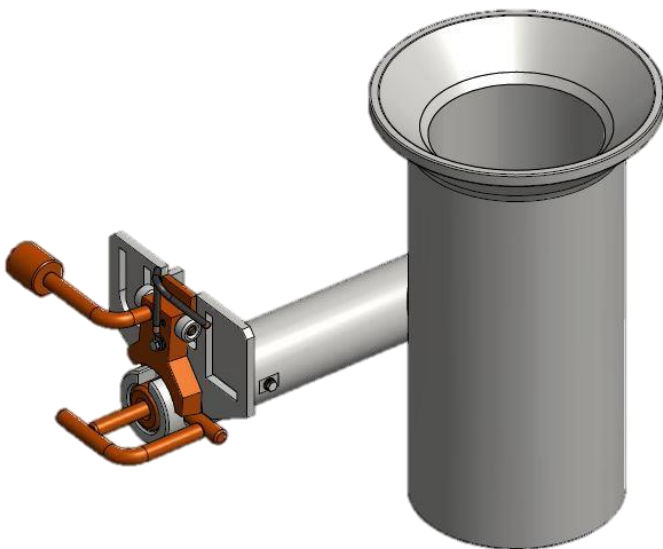

Receptacle for bottom releasable guidepost



Standard slimline anchor



Standard Anchor